







Tools Needed:

-  2.0 - 2.5 mm Hex Driver
-  Phillips Screw Driver
-  Small Container for Screws

Optional Tools:

-  Bottle of Compressed
-  Pair of needle nose pliers

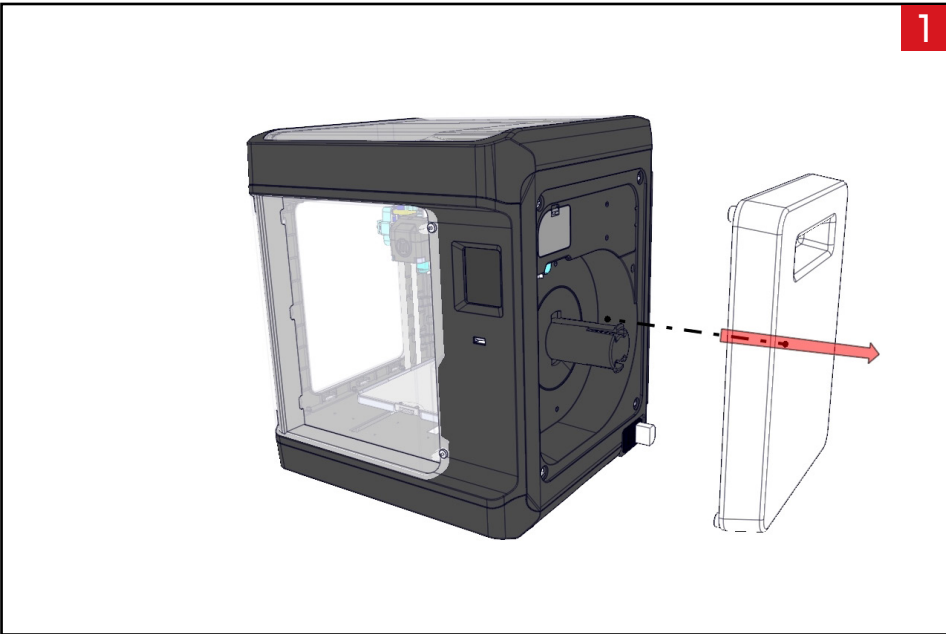

●

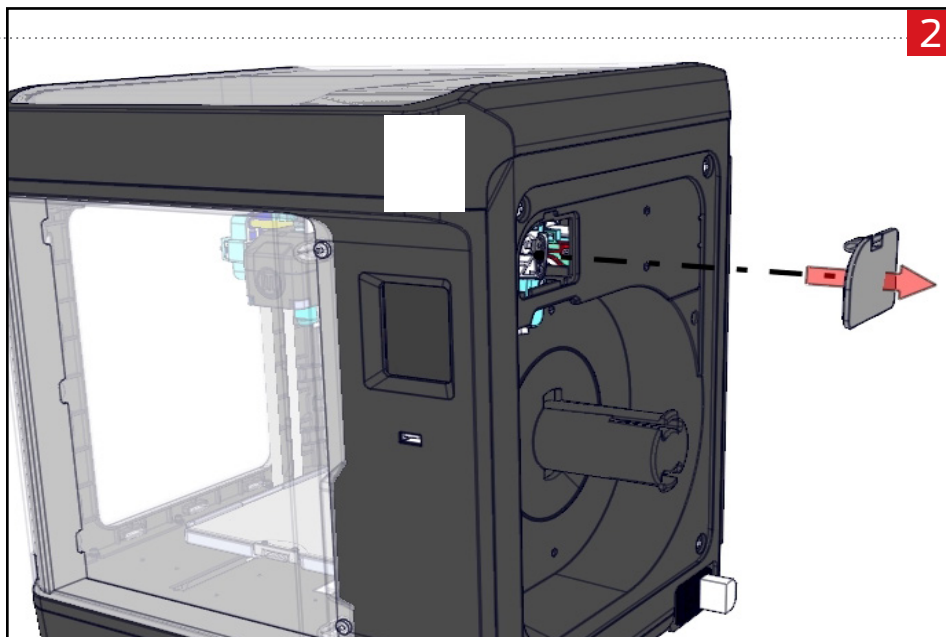

● Remove the cover to expose the
ADS Motor Assembly

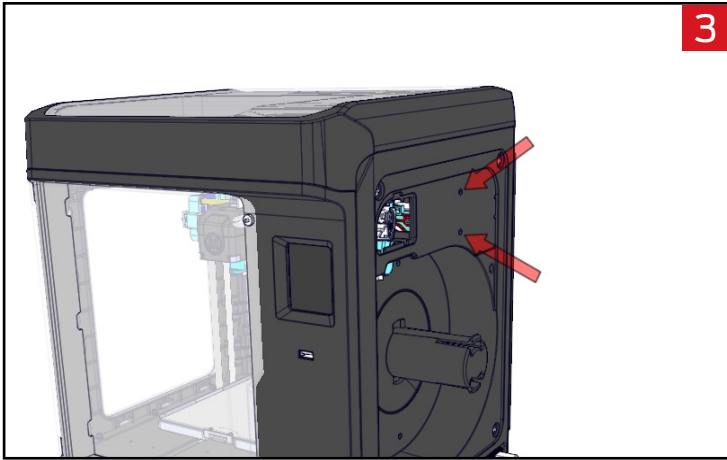

- Using a 2.0 mm screwdriver remove the two (2) small flat head screws covering the **ADS motor**

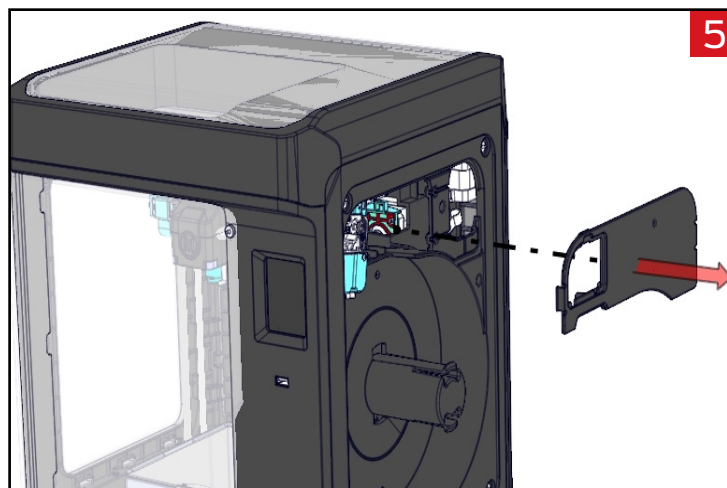
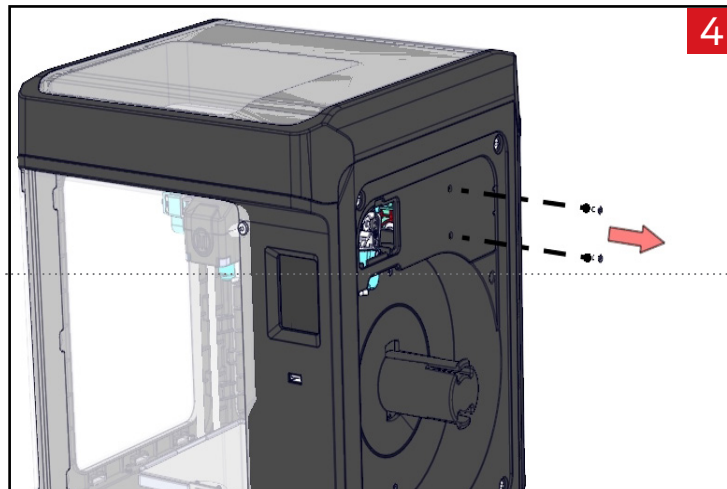

- Remove **Cover** and set aside

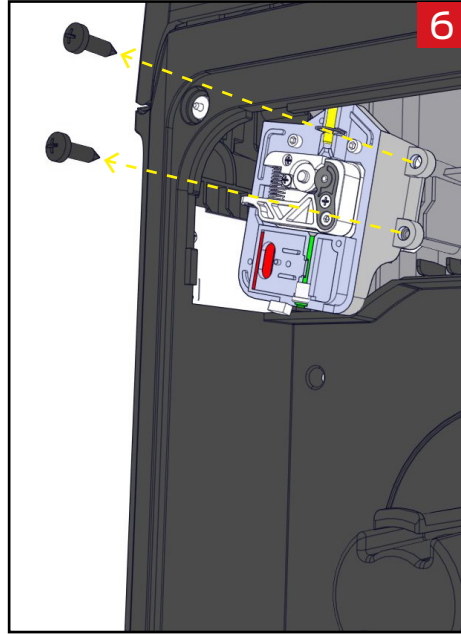
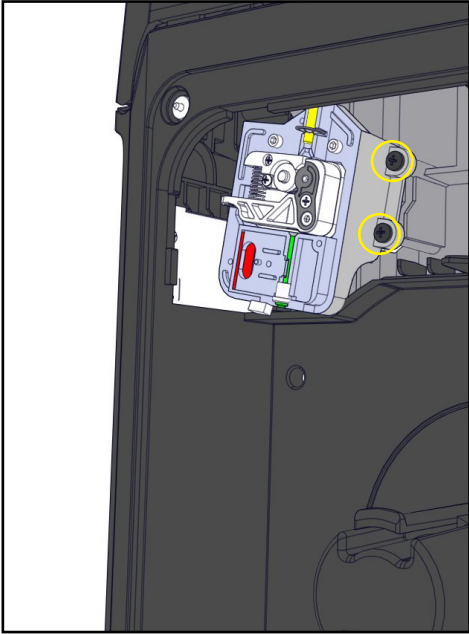

- Locate the two (2) thread former screws that are attaching the **ADS Cover** on to the **ADS Assembly**

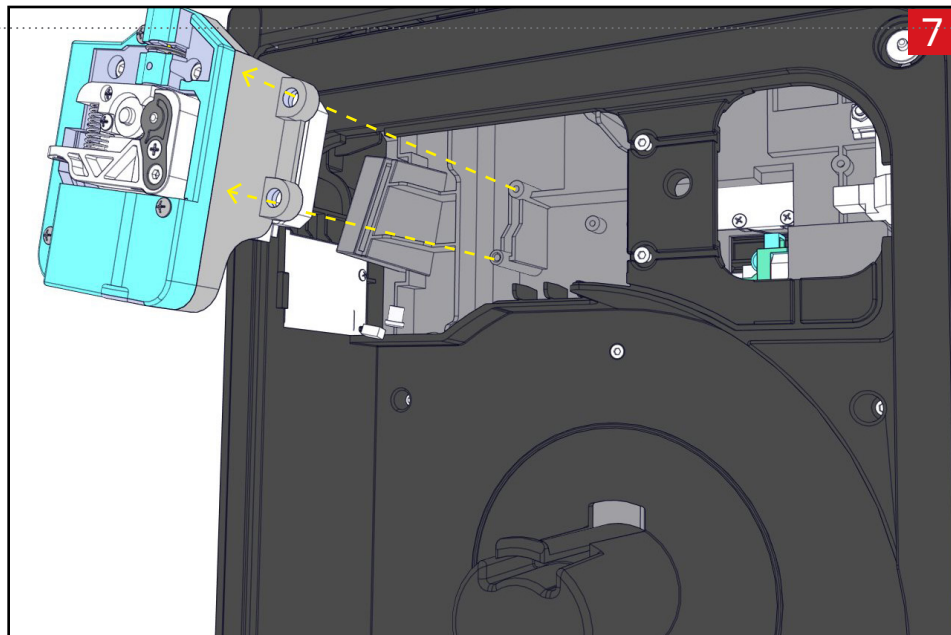

- Carefully remove the ADS Assembly out of the SKETCH printer and be mindful not to damage the cable connections as cable length is limited.

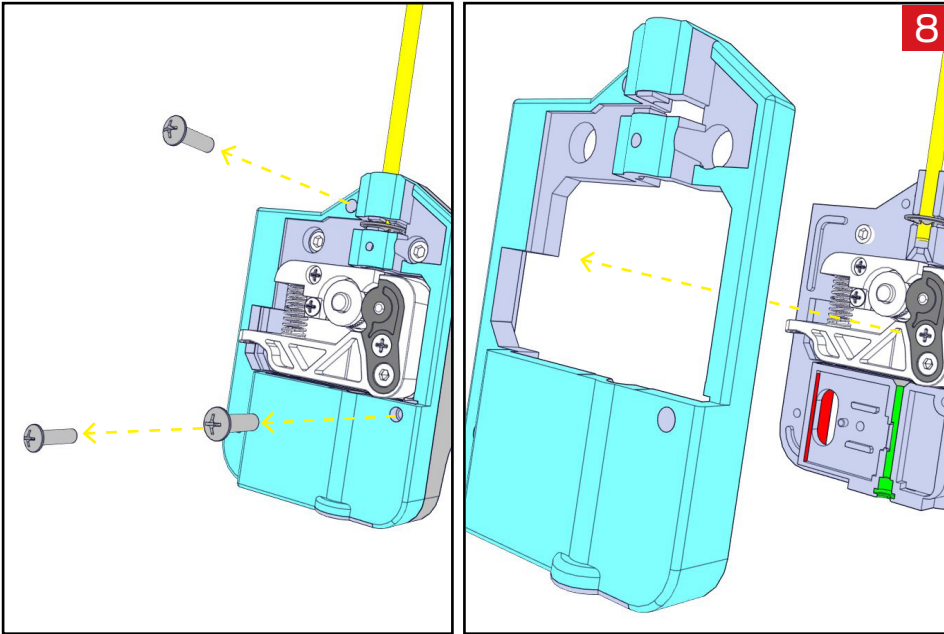

- Using a phillips head screw driver remove the three (3) screws and remove the **ADS Motor Assembly Cover**

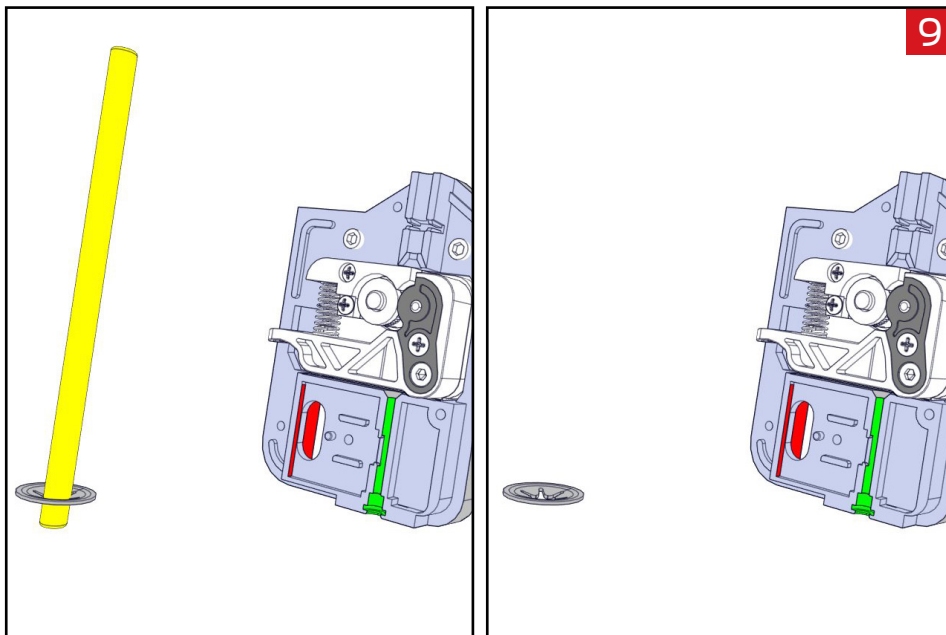
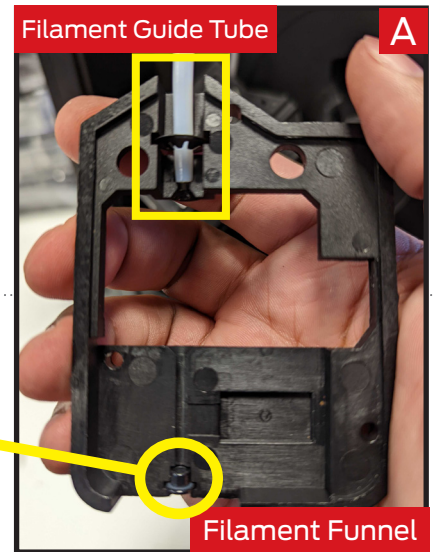
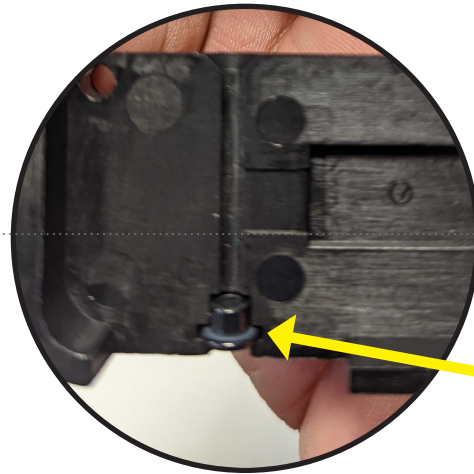

- Remove both the **Filament Guide Tube** and the **Retaining Ring**
- Detach the **Retaining Ring** from the previous **Filament Guide Tube**, then attach it securely onto the new **Filament Guide Tube**

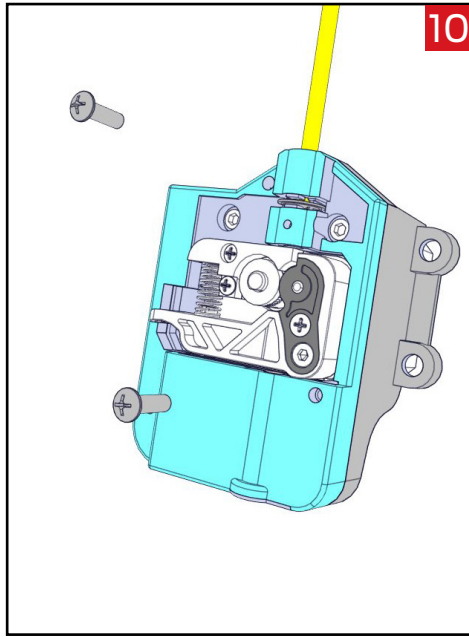
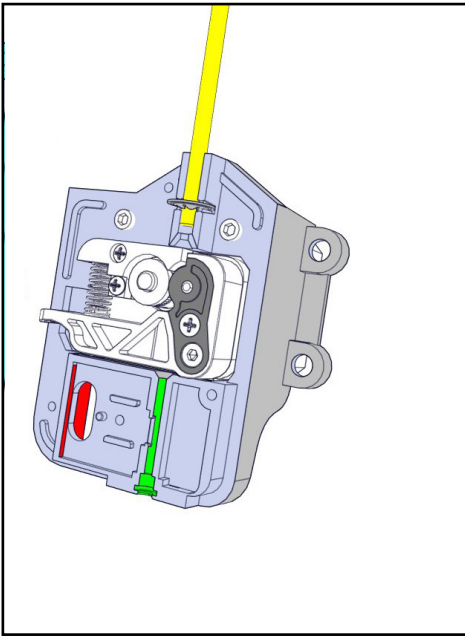

- Place slide Retention Ring and Filament guide tube back in to its designated place, also make sure that the Filament Funnel is also back in its place

**See Image A in step 7*

- Screw back on the **ADS Assembly Cover** using the three

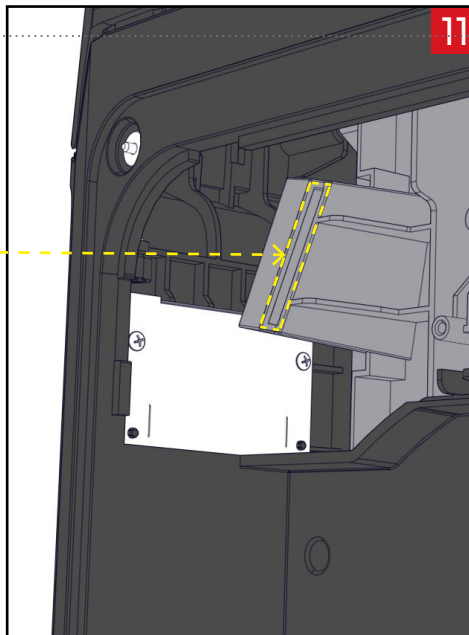
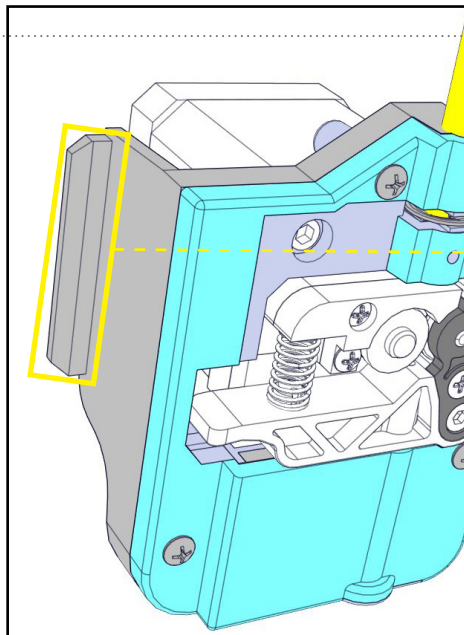

- Pay attention to the tab located on the ADS Assembly. Slide it into the corresponding notch to ensure the **ADS Assembly** is securely mounted back on the printer.

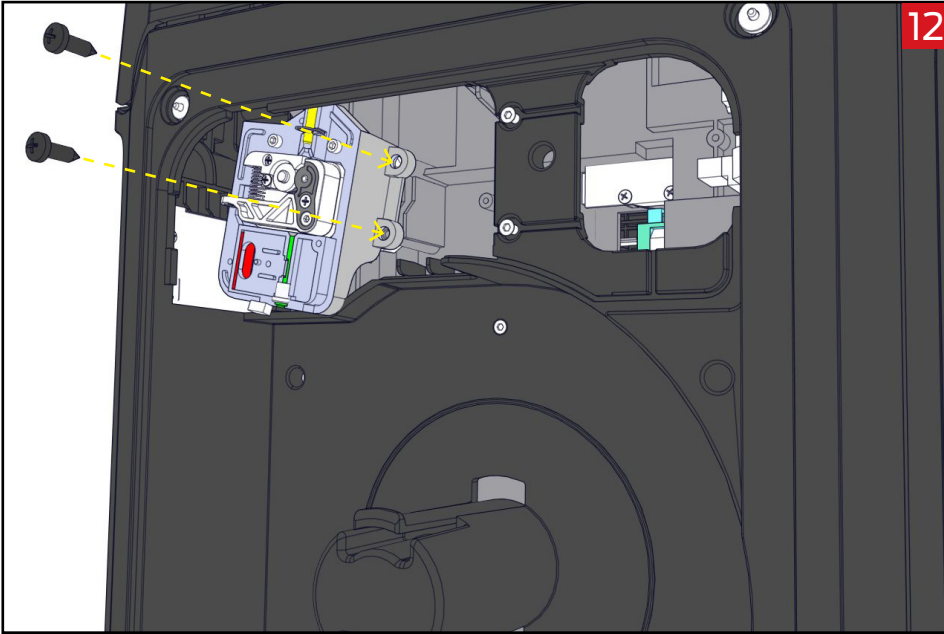

- Once the **ADS Assembly** has been correctly resealed, use two (2) Phillips screws to securely fasten it back onto the printer

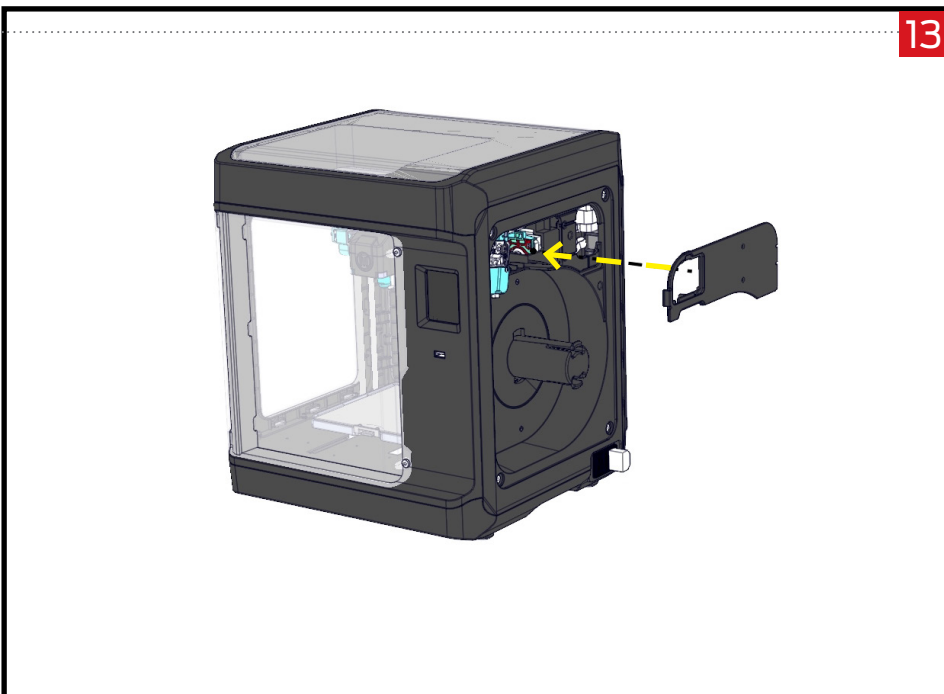

- Once the **ADS Assembly Cover** is secure in place, close the opening by re-attaching the **ADS Motor Cover**.

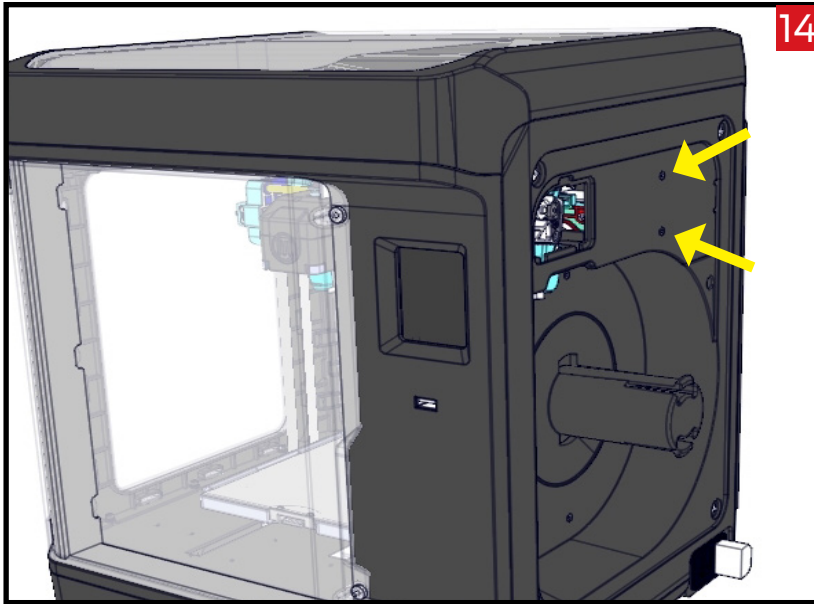

- Secure in place with the two (2) flat head screws using the 2.0mm screwdriver.

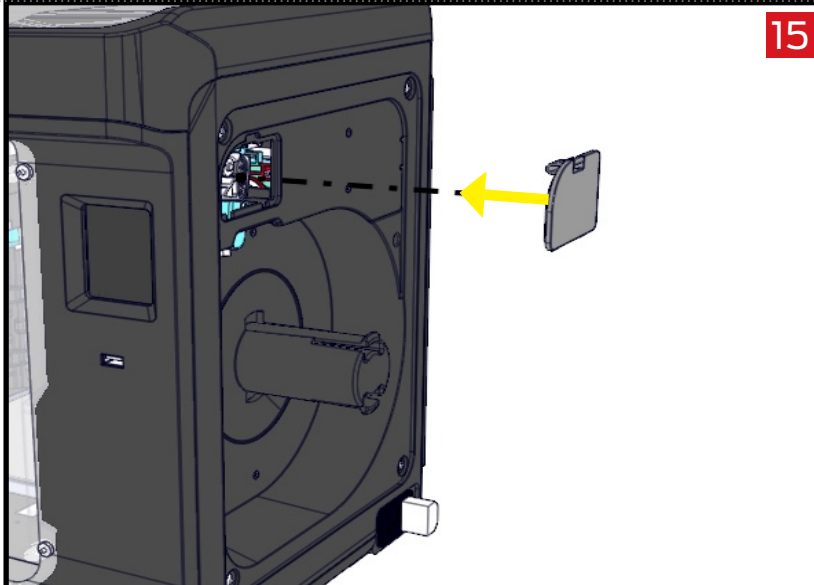

- Re-attached **Ads Door Latch**
- Turn on printer and reload your filament: **Material > Load** wait until printer reaches temperature. Trim the tip of the filament and when the printer reaches temperature insert the filament into the **ADS** and wait for filament to extrude. Once filament is extruding hit next and your printer will be ready to print. Feel free to run a quick test print.

If you have any questions or need any assistance please call or email MakerBot support.